



MOUNT VERNON
HISTORICAL REVIEW COMMISSION
MINUTES • MARCH 14, 2024

Regular Meeting

Council Chambers

4:00 PM

40 Public Square, Mount Vernon, OH 43050

I. VIDEO BROADCASTING & RECORDING

The meeting videos are now being broadcast live and published on YouTube.com
<https://www.youtube.com/@cityofmountvernon3369>

II. CALL TO ORDER

Attendee Name	Title	Status
Tanner Salyers	Safety Service Director	Present
Jason West	Alt. Member	Excused
Anne Ellsworth	Member	Present
Eric Diehl	Alt. Member	Excused
Lacey Filkins	Member	Present
Todd Hawkins	Member	Present
Sibley Poland	Member	Present
Matthew T. Starr	Mayor, Chairman	Present
Austin Swallow	Member	Present

Others in attendance: City Engineer, Brian Ball; City Development Services Manager, Lacie Blankenhorn; City Law Director, P. Rob. Broeren; Jay Mahan; Mearl & Marilyn Wolf; Jeff Gottke; Cheryl Splain; Adelyn Steinmetz; Rachel Smith; Olivia Stein; Matthew Teismann; Brady Kaufman; Sabina Hawks; Max Hentosh; et al

III. MINUTES APPROVAL

- Historical Review Commission - Regular Meeting - Dec 14, 2023 4:00 PM

RESULT:	ACCEPTED [UNANIMOUS]
MOVER:	Tanner Salyers, Safety Service Director
SECONDER:	Todd Hawkins, Member
AYES:	Salyers, Ellsworth, Filkins, Hawkins, Poland, Starr, Swallow
EXCUSED:	West, Diehl

IV. HRC-ITEM NUMBERS

- 2024-HRC-01 - Certificate of Appropriateness for 117 E High ST

Blankenhorn introduced the case.

Tiesmann of MKC Architects (sworn in) explained that the Knox County Commissioners are looking to improve the north, rear entry to 117 E High ST, the county service building. The rear entry is the main entry used by most of the employees and the public. It is the only accessible entrance to the building. A new vestibule and lobby will improve the sequencing and allow more accessibility and access to the building, as well as cover the loading dock. The proposed entrance addition serves to signify and improve the building entrance, including new lighting fixtures and improved signage. As part of the addition, the project also includes a renovation to the existing building facade. The existing material is a yellow brick. The brick would be clad with metal panels to match the proposed addition and the nearby Board of Elections building that was renovated in 2019 across

the street. The ground slopes toward the building, causing water damage and maintenance challenges. The proposed addition will feature a stone finish. The design is inspired by the history of the founding of Mount Vernon and the natural vernacular stone deposits of the glaciated Alleghany plateau to create the ground on which Mount Vernon rests today. An emphasis was placed on designing an entry that differentiates and dignifies itself through form, while also drawing inspiration from the historic nature of Mount Vernon. The exterior metal panels match the nearby Knox County Board of Elections building by the request of the Commissioners and define a cohesive updated look to the buildings commonly used entry point and surrounding County campus. The conjoined loading dock enclosure includes a new overhead door which will match adjacent overhead doors on the vehicle service building to the left of the entrance, reinforcing consistency on the Northeast portion of the site. This is an addition, not meant to be historic preservation of the façade. As such the design differentiates from the architecture of the building and recladding only the rear component of the building inside the courtyard to provide cohesion and protection from the water.

There was no further testimony and no communications submitted through the Development Services Manager. There were no law and engineering concerns. Ball said there are no issues as far as utilities conflicts or city infrastructure negatively effecting the proposal.

Filkins made a motion to accept the proposal for a Certificate of Appropriateness.

RESULT:	ACCEPT [UNANIMOUS]
MOVER:	Lacey Filkins, Member
SECONDER:	Tanner Salyers, Safety Service Director
AYES:	Salyers, Ellsworth, Filkins, Hawkins, Poland, Starr, Swallow
EXCUSED:	West, Diehl

V. ADJOURN

1. Adjourn Motion

Swallow made a motion to adjourn the meeting, Poland seconded and the meeting was adjourned at 4:07 PM

RESULT:	ADOPTED [UNANIMOUS]
MOVER:	Austin Swallow, Member
SECONDER:	Sibley Poland, Member
AYES:	Salyers, Ellsworth, Filkins, Hawkins, Poland, Starr, Swallow
EXCUSED:	West, Diehl



Historical Review Commission
40 Public Square
Mount Vernon, OH 43050

Meeting: 03/14/24 4:00 PM
 Dept: **Historical Review Commission**

SCHEDULED

Category: N/A
 Prepared By: Lacie Blankenhorn
 Initiator: Lacie Blankenhorn

HRC-ITEM NUMBER (ID # 3980)

DOC ID: 3980

2024-HRC-01 - CERTIFICATE OF APPROPRIATENESS FOR 117 E HIGH ST

Per City of Mount Vernon Planning and Zoning Code Chapter 1172, Historic District as request for a Certificate of Appropriateness has been submitted for a new lobby addition and loading dock enclosure at 117 E High ST.

COMMENTS - Current Meeting:

Blankenhorn introduced the case.

Tiesmann of MKC Architects (sworn in) explained that the Knox County Commissioners are looking to improve the north, rear entry to 117 E High ST, the county service building. The rear entry is the main entry used by most of the employees and the public. It is the only accessible entrance to the building. A new vestibule and lobby will improve the sequencing and allow more accessibility and access to the building, as well as cover the loading dock. The proposed entrance addition serves to signify and improve the building entrance, including new lighting fixtures and improved signage. As part of the addition, the project also includes a renovation to the existing building facade. The existing material is a yellow brick. The brick would be clad with metal panels to match the proposed addition and the nearby Board of Elections building that was renovated in 2019 across the street. The ground slopes toward the building, causing water damage and maintenance challenges. The proposed addition will feature a stone finish. The design is inspired by the history of the founding of Mount Vernon and the natural vernacular stone deposits of the glaciated Alleghany plateau to create the ground on which Mount Vernon rests today. An emphasis was placed on designing an entry that differentiates and dignifies itself through form, while also drawing inspiration from the historic nature of Mount Vernon. The exterior metal panels match the nearby Knox County Board of Elections building by the request of the Commissioners and define a cohesive updated look to the buildings commonly used entry point and surrounding County campus. The conjoined loading dock enclosure includes a new overhead door which will match adjacent overhead doors on the vehicle service building to the left of the entrance, reinforcing consistency on the Northeast portion of the site. This is an addition, not meant to be historic preservation of the façade. As such the design differentiates from the architecture of the building and recladding only the rear component of the building inside the courtyard to provide cohesion and protection from the water.

There was no further testimony and no communications submitted through the Development Services Manager. There were no law and engineering concerns. Ball said there are no issues

as far as utilities conflicts or city infrastructure negatively effecting the proposal.

Filkins made a motion to accept the proposal for a Certificate of Appropriateness.

RESULT:	ACCEPT [UNANIMOUS]
MOVER:	Lacey Filkins, Member
SECONDER:	Tanner Salyers, Safety Service Director
AYES:	Salyers, Ellsworth, Filkins, Hawkins, Poland, Starr, Swallow
EXCUSED:	Jason West, Eric Diehl



City of Mount Vernon, Ohio
Historic Review Commission

Application for Certificate of Appropriateness

Applicant:

Name: _____

Address: _____

Email: _____ Phone: _____

Site Information:

Address: _____

Parcel Number: _____ Deed Volume and Page: _____

Zoning District: _____

Owner: _____

Address: _____

Project Description: New lobby addition, loading dock enclosure, and north facade + penthouse re-cladding

Site plans, building elevations, renderings, and any other drawings, details, or brochures, as well as the detailed narrative statements must be attached to this application.

Projects that required a Public Hearing require a \$75.00 deposit. Applicant will be billed for any costs which exceed the deposit. General maintenance projects typically do not require a Public Hearing.

Applicant hereby certifies that the information submitted on this application and on any sketches, drawings or other documents required to be submitted with the application are true and exact.

Signature of Applicant _____

Date _____

FOR OFFICIAL USE ONLY

Case No.: _____

Knox County Service Center: North Entry Addition

MKC | ARCHITECTS

Historic District Review

The attached documentation accompanies an application for a Certificate of Appropriateness by the City of Mount Vernon Historic Review Commission regarding a new addition to the Knox County Service Center requested by the Knox County Commissioners.

Project Scope

Knox County Commissioners are looking to improve the rear entry [North] into their Service Center building with a 2,000sf building addition. Currently the rear entrance serves as the building's only accessible entry. This project improves the accessibility of the entrance with a new lobby and vestibule space and encloses the existing loading area with a new garage [1,000sf each]. The project improves existing site grading concerns of water penetration. The current grading slopes toward the building and is causing maintenance problems.

The proposed entrance addition serves to signify and improve the building entrance, including new lighting fixtures and improved signage. As part of this addition, the project also includes a renovation to the existing building façade at that location. The existing material is a yellow brick. This brick would be clad with metal panels to match the proposed addition and the nearby Board of Elections building that was renovated in 2019.

Project Prompt

The current north entrance is connected to a network of parking lots, serving as the primary entry for employees and the public. Existing conditions, however, cause a disconnect between access and entry. For this reason, a new lobby addition is proposed that encloses the adjacent loading dock. The new addition is designed as a barrel-vaulted inspired from the pedestals on the southside entry of the Service Center which function as a gateway from the street. The new storefront entrance is covered from the overall building mass and will feature a stone finish. The design is inspired by the history of the founding of Mt. Vernon and the natural vernacular - stone deposits of the Glaciated Allegheny Plateau - to create the ground on which Mount Vernon rests today.

Design Intent

An emphasis was placed on designing an entry that differentiates and dignifies itself through form, while also drawing inspiration from the historic nature of Mount Vernon. The exterior metal panels match the nearby Knox County Board of Elections building by request of the Commissioners and define a cohesive updated look to the building's commonly used entry point and surrounding county campus.

The conjoined loading dock enclosure includes a new overhead door, which will match adjacent overhead doors on the vehicle service building, reinforcing consistency on the northeast portion of the site.

Attachment: kcsc_cover_letter_2024.02.12 (3980 : 2024-Hrc-01)

KNOX COUNTY SERVICE CENTER NORTH ENTRY ADDITION



117 E. HIGH STREET, MT. VERNON OHIO 43050

SUBMITTAL CONTENTS

-] Project Narrative
- 2] Existing Conditions
- 3] Adjacent Properties
- 5] Site Plan
- 6] Site Plan : Addition
- 7] Massing Diagram
- 8] Building Elevation
- 9] Rendered Elevation
- 10] Exterior Rendering

PROJECT NARRATIVE

The Knox County Service Center functions as the primary entry for many members of the public and employees alike. However, existing conditions cause a disconnect between the building approach, access, and entry. For this reason, The Knox County Commissioners have requested an addition design including a new lobby addition, recladding of the existing north facade, and enclosure of the adjacent loading dock.

The new addition takes its barrel-vaulted inspiration from the pedestals on the southside entry of the Service Center which function as a gateway from the street. The new recessed entryway is carved from the overall mass and highlighted with a stone-like finish. The design is inspired by the historic narrative and Mount Vernon's shaping and stone deposits of the Glaciated Allegheny Plateau which carved away land to create the ground on which Mount Vernon rests today.

An emphasis was placed on designing an entry that pulls from the historic nature of Mount Vernon, while employing a contemporary form that will define the procession for decades to come. The exterior metal panel pulls inspiration from a nearby elevator shaft addition on the Knox County Board of Elections building by request of the Commissioners. The design proposal uses the same material to re-clad the existing north wall and define a cohesive updated look to the building's commonly used entry point.





RED BRICK WILL BE PRESERVED

YELLOW BRICK FACADE TO BE RE-CLAD

CANOPY TO BE REMOVED

Attachment: historic_review_presentation_2024.02.12 (3980 : 2024-Hrc-01)



WEST, FACING SOUTH FROM E. SUGAR ST.
RENOVATED 2019, METAL PANEL REFERENCE.



WEST - FACING SOUTH; WEST PARKING LOT

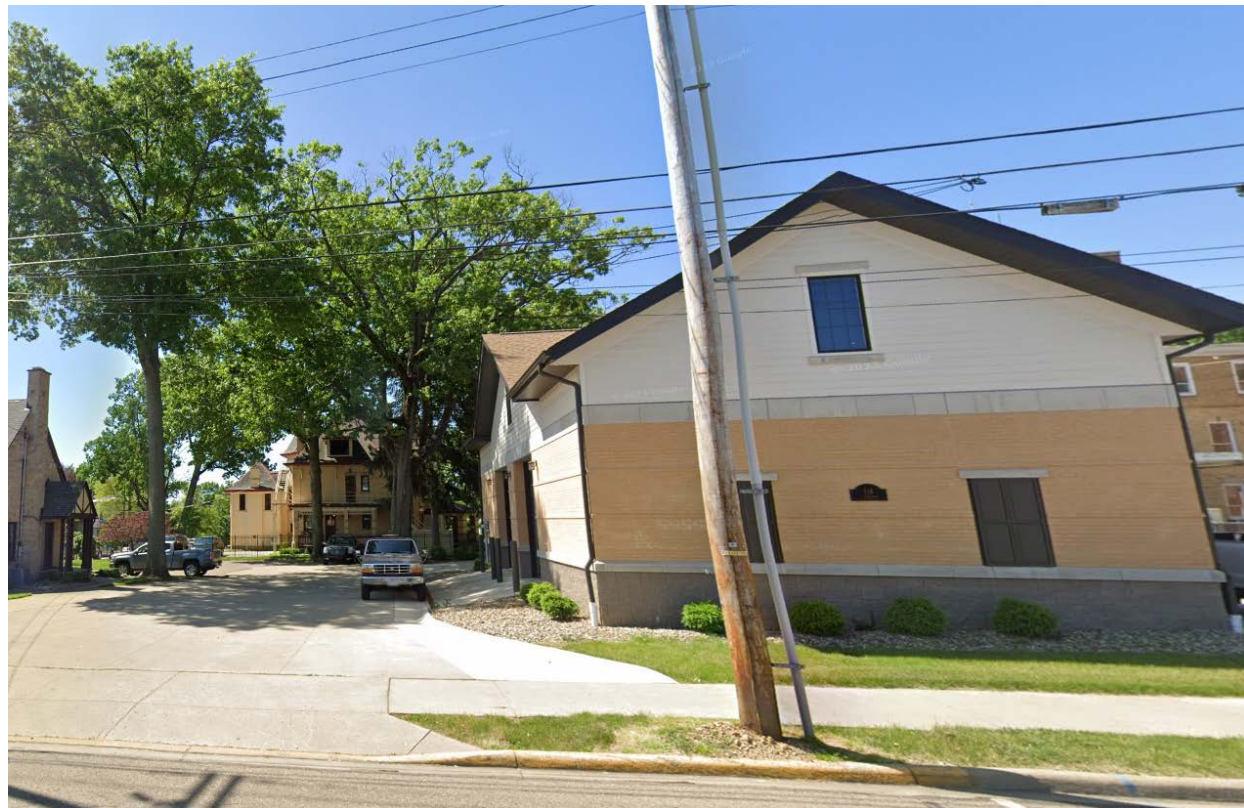

EAST - FACING SOUTH; EAST VEHICLE SERVICE BUILDING



WEST - FACING NORTH ACROSS CHESTNUT

Attachment: historic_review_presentation_2024.02.12 (3980 : 2024-Hrc-01)

ADJACENT PROPERTIES



WEST, FACING NORTH FROM HIGH ST.



NORTH, FACING NORTH FROM CHESTNUT; NORTH PARKING LOT



SOUTH, FACING SOUTH FROM HIGH ST.



EAST - FACING NORTH FROM HIGH ST.

Attachment: historic_review_presentation_2024.02.12 (3980 : 2024-Hrc-01)

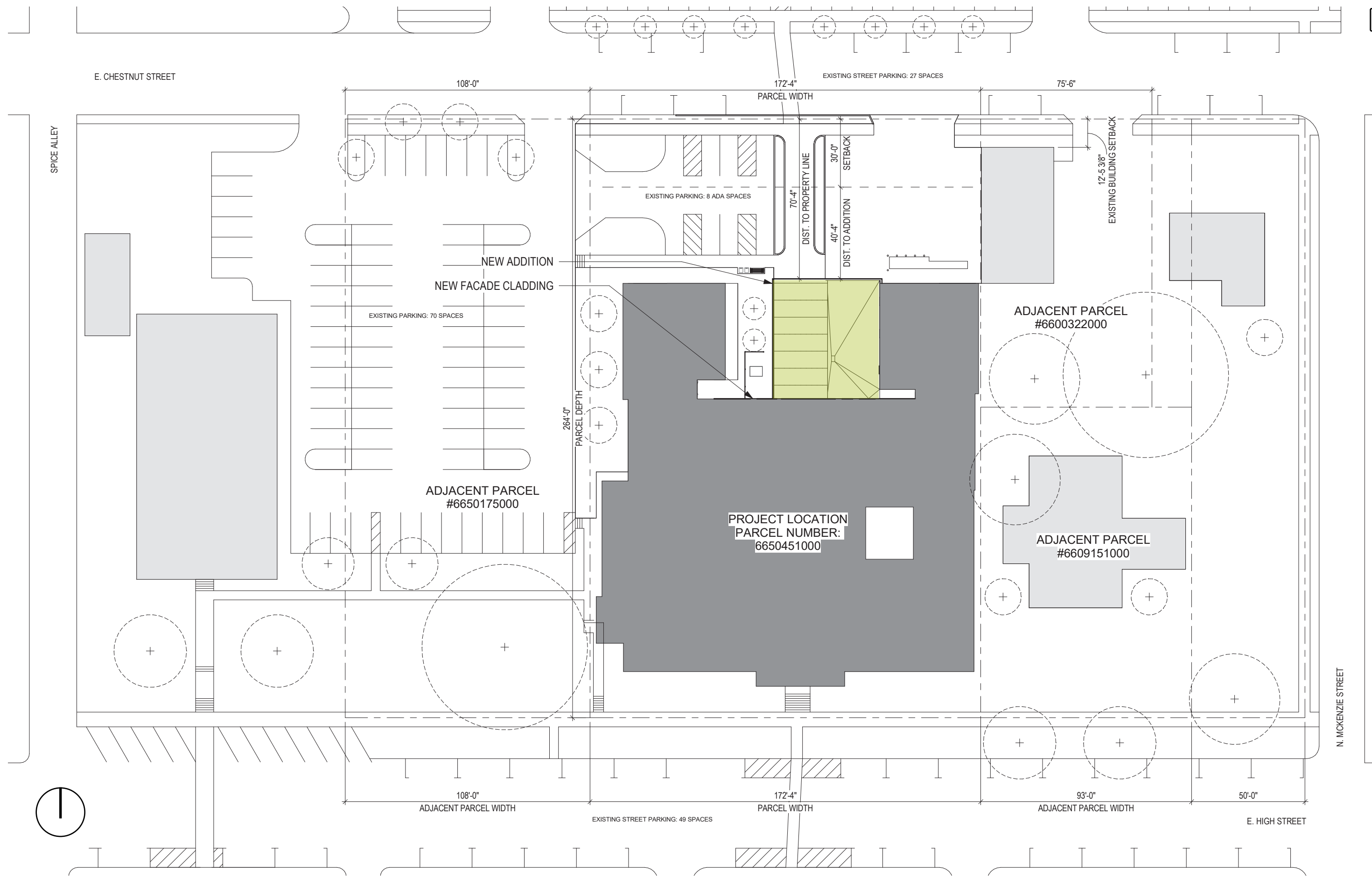

Attachment: historic_review_presentation_2024.02.12 (3980 : 2024-Hrc-01)

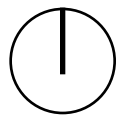

SITE PLAN

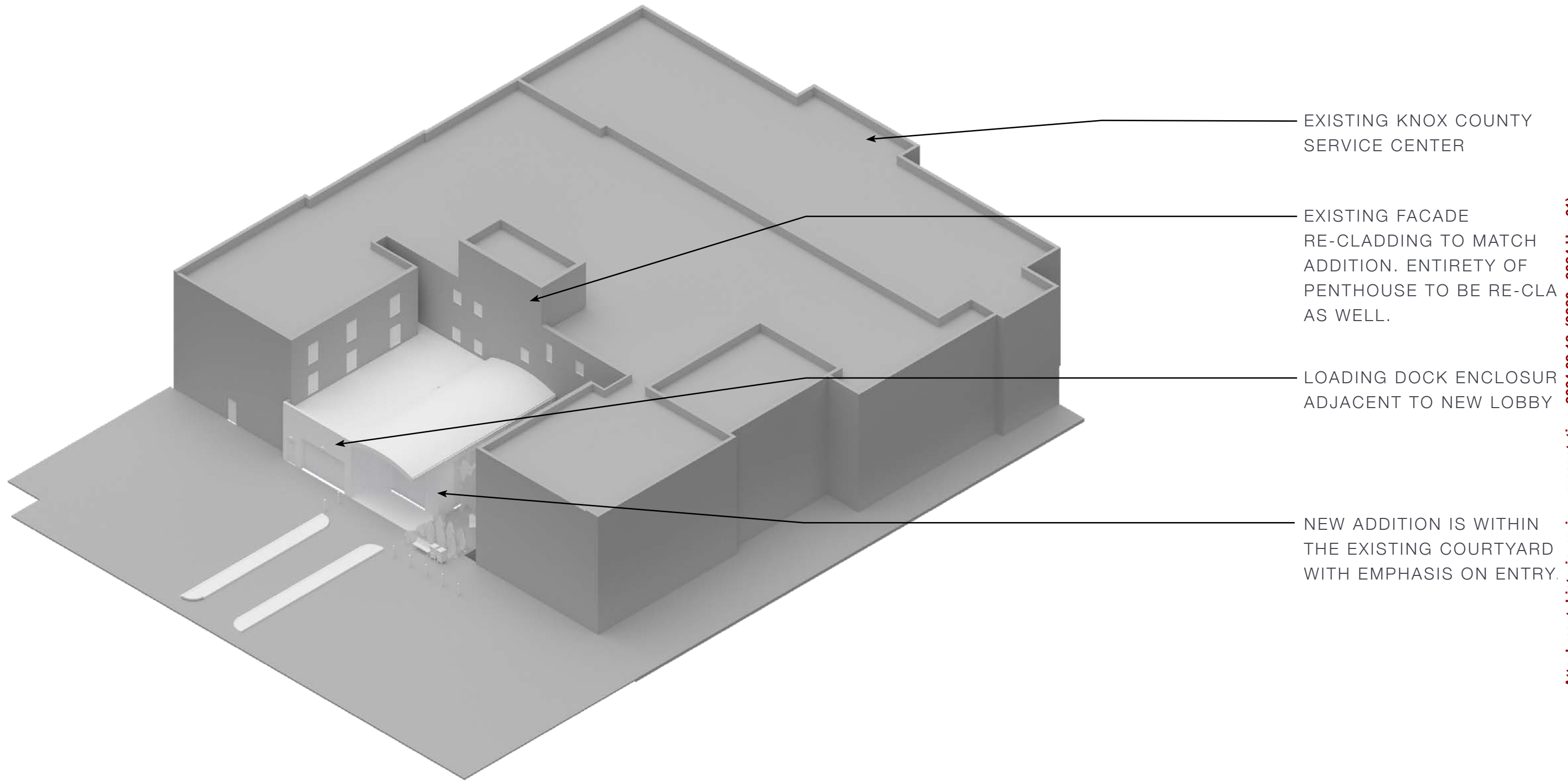

Attachment: historic_review_presentation_2024.02.12 (3980 : 2024-Hrc-01)



NEW BRONZE METAL PANEL

NEW ADDITION.



KNOX COUNTY
SERVICE CENTER

Attachment: historic_review_presentation_2024.02.12 (3980 : 2024-Hrc-01)



NORTH ELEVATION
RENDERING





Attachment: historic_review_presentation_2024.02.12 (3980 : 2024-Hrc-01)